

Digital Mini Height Gauge 192 Series

Features

- Large LCD display
- Functions: mm / inch / fractional, ABS, Hold
- Solid aluminium alloy base with magnets
- Hardened stainless steel beam
- IP54 water, dust and oil resistant protection



DIGITAL MINI HEIGHT GAUGE

Code No	Range (mm)	Range (inch)	Accuracy (mm)	Accuracy (inch)
MW192-20D	0-150	0-6	0.03	0.001

Digital Height Gauge 190 Series

Features

- Easy to read LCD display
- Functions: mm/inch conversion, on/off, zero setting, battery low indication
- Soft keys for maximum operating comfort
- Ground micro-lapped measuring surfaces
- Fine adjustment for high precision measurement



DIGITAL HEIGHT GAUGE

Code No	Range (mm)	Range (inch)	Resolution (mm)	Resolution (inch)	Accuracy (mm)	Size of Base (mm)
MW190-30DBL	0-300	0-12	0.01	0.001	0.04	90 x 140
MW190-50DBL	0-500	0-20	0.01	0.001	0.05	120 x 180
MW190-60DBL	0-600	0-24	0.01	0.001	0.05	120 x 180

Digital Height Gauge 193 Series

Features

- Easy to read LCD Display
- Functions: mm/inch conversion, on/off, zero setting, battery low indication
- Ground & Micro lapped measuring surfaces
- Fine adjustment for high precision measurement
- Hand wheel operation with positive lock
- Supplied with carbide tipped scriber



DIGITAL HEIGHT GAUGE

Code No	Range (mm)	Resolution (mm)	Repeatability (mm)	Accuracy (mm)
MW193-30DDL	0-300	0.01	0.01	+/- 0.040
MW193-60DDL	0-600	0.01	0.01	+/- 0.050

Double Column Digital Height Gauge 195 Series

Features

- Carbide tipped scriber
- Large 7.5mm high, digital display
- Soft keys for maximum operating comfort
- Ground micro-lapped measuring surfaces
- Functions: mm/inch conversion, on/off, data-output, zero-setting, max, min, battery low indication



DIGITAL DOUBLE COLUMN HEIGHT GAUGE

Code No	Range (mm)	Range (inch)	Resolution (mm)	Resolution (inch)	Accuracy (mm)	Size of Base (mm)
MW195-30DDL	0-300	0-12	0.01	0.0005	0.03	125 x 85
MW195-60DDL	0-600	0-24	0.01	0.0005	0.06	180 x 120

Traditional External Micrometer 1961 Series

Features

- Standard: BS870, DIN 863/1, ISO361
- Tungsten carbide measuring faces
- 5 mm spindle diameter
- Tapered bow frame
- Pearl-chrome plated frame with insulation pads
- Speeder type ratchet
- Choice of standard or vernier type sleeve
- Locking lever
- Adjusting key
- Supplied in plastic pocket case



MECHANICAL EXTERNAL MICROMETER

Code No	Range (mm)	Resolution (mm)	Code No	Range (inch)	Resolution (inch)
1961M	0-25	0.01	1961	0-1	0.001
1961MB	0-25	0.002	1961B	0-1	0.0001

ACCURACY

Micrometer Range Max Size up to	Measuring Faces Flatness	Screw Pitch Parallelism	Accuracy
25mm	0.001mm	0.003mm	0.003mm
1"	0.00005"	0.0001"	0.0001"

Traditional External Micrometer 1965 Series

Features

- Standard: BS870, DIN 863/1, ISO361
- Tungsten carbide measuring faces
- 6.5mm spindle diameter
- Blue textured tapered bow frame
- Speeder type ratchet
- Choice of standard or vernier type sleeve
- Locking lever
- Adjusting key
- Supplied in plastic pocket case



MECHANICAL EXTERNAL MICROMETER

Code No	Range (mm)	Resolution (mm)	Code No	Range (inch)	Resolution (inch)
1965M	0-25	0.01	1965	0-1	0.001
1965MB	0-25	0.002	1965B	0-1	0.0001

ACCURACY

Micrometer Range Max Size up to	Measuring Faces Flatness	Screw Pitch Parallelism	Accuracy
25mm	0.001mm	0.003mm	0.003mm
1"	0.00005"	0.0001"	0.0001"

Traditional External Micrometers, 966 Series

Complies with: BS870, DIN 863/1, ISO361

966 Series Features:

- Tungsten carbide measuring faces
- Blue textured frame finish
- Speeder type ratchet
- Locking lever
- Adjusting key
- Supplied in case
- Choice of standard or vernier type sleeve
- Spindle diameter 6.5mm
- Supplied with setting standard



MOORE & WRIGHT MICROMETER SETTING STANDARDS

Metric Code No	Length (mm)	Tolerance +/- (mm)	Imperial Code No	Length (inch)	Tolerance +/- (inch)
980M25	25	0.001	9801	1	0.00005
980M50	50	0.002	9802	2	0.0001
980M75	75	0.002	9803	3	0.0001
980M100	100	0.002	9804	4	0.0001
980M125	125	0.002	9805	5	0.0001

Hardened and Ground Steel Measuring Faces with Spherical Ends Fitted Insulating Sleeve Marked with Nominal Size

ACCURACY

Micrometer Range	Measuring Faces		Screw Pitch Accuracy	
	Max Size up to	Flatness		Parallelism
50mm	2"	0.001mm	0.003mm	0.003mm
150mm	6"	0.001mm	0.005mm	0.003mm
		0.0005"	0.0002"	0.0001"

MECHANICAL EXTERNAL MICROMETERS - METRIC: 25-150MM

Code No	Range (mm)	Description	Code No	Range (mm)	Description
1966M50	25-50	0.01mm Carbide anvils	1966MB50	25-50	0.002mm Carbide anvils
1966M75	50-75	0.01mm Carbide anvils	1966MB75	50-75	0.002mm Carbide anvils
1966M100	75-100	0.01mm Carbide anvils	1966MB100	75-100	0.002mm Carbide anvils
1966M125	100-125	0.01mm Carbide anvils	1966MB125	100-125	0.002mm Carbide anvils
1966M150	125-150	0.01mm Carbide anvils	1966MB150	125-150	0.002mm Carbide anvils

MECHANICAL EXTERNAL MICROMETERS - IMPERIAL: 1-6"

Code No	Range (inch)	Description	Code No	Range (inch)	Description
19662	1-2	0.001" Res, Carbide anvils	1966B2	1-2	0.0001" Res, Carbide anvils
19663	2-3	0.001" Res, Carbide anvils	1966B3	2-3	0.0001" Res, Carbide anvils
19664	3-4	0.001" Res, Carbide anvils	1966B4	3-4	0.0001" Res, Carbide anvils
19665	4-5	0.001" Res, Carbide anvils	1966B5	4-5	0.0001" Res, Carbide anvils
19666	5-6	0.001" Res, Carbide anvils	1966B6	5-6	0.0001" Res, Carbide anvils

Micrometer Ball Attachment

Features

- Can be fitted to the anvil or spindle of external micrometer series 1961, 1965 and 1966 to enable round or irregular surfaces to be measured
- The ball is hardened and moves freely to allow contact with the object being measured

Note: Always deduct the ball diameter from any reading.



MICROMETER BALL ATTACHMENT

Code No	Description	Diameter (mm)	Diameter (inch)	Note
878M	6.5mm and 6.8mm	6.5 ball	-	1 of each spindle size supplied
878	0.256" and 0.268"	-	0.250 ball	1 of each spindle size supplied

Workshop Outside Micrometer 200 Series

Features

- Standard: DIN 863
- Standard workshop model
- Resolution 0.01mm
- Satin-chrome scale
- Painted frame
- Tapered for easier access to difficult areas
- With tungsten carbide measuring face and constant force ratchet
- Packed in plastic box with standard and adjusting key



METRIC

Code No	Range (mm)	Resolution (mm)
MW200-01BL	0-25	0.01
MW200-02BL	25-50	0.01
MW200-03BL	50-75	0.01
MW200-04BL	75-100	0.01

External Micrometer 200 Series

Features

- Standard: DIN 863 / 1
- Tungsten carbide measuring faces
- Satin chrome scale
- Hammertone finish frame with insulated grip
- Tapered for easier access to difficult areas
- Constant force ratchet on thimble
- Locking lever
- Adjusting key
- Supplied in case with setting standard



METRIC

Code No	Range (mm)	Resolution (mm)
MW200-01	0-25	0.01
MW200-02	25-50	0.01
MW200-03	50-75	0.01
MW200-04	75-100	0.01

IMPERIAL

Code No	Range (inch)	Resolution (inch)
MW200-01I	0-1	0.0005
MW200-02I	1-2	0.0005
MW200-03I	2-3	0.0005
MW200-04I	3-4	0.0005

Workshop Digital Micrometer 200 Series

Features

- Standard: DIN 863
- Large LCD display
- Functions: mm/inch conversion, ABS/INC, on/off, zero-setting
- Tungsten carbide measuring faces
- Hammertone finished frame with high quality insulated grip
- Tapered for easier access to difficult areas
- Constant force ratchet on thimble
- Locking lever
- Supplied with settings standard over 25mm
- Supplied in case



WORKSHOP DIGITAL EXTERNAL MICROMETER

Code No	Range (mm)	Range (inch)	Resolution (mm)	Resolution (inch)
MW200-01DBL	0-25	0-1	0.001	0.00005
MW200-02DBL	25-50	1-2	0.001	0.00005
MW200-03DBL	50-75	2-3	0.001	0.00005
MW200-04DBL	75-100	3-4	0.001	0.00005

Digital External Micrometer 201 Series

Features

- Standard: DIN 863
- Protected to IP54 specifications
- Large LCD display
- Digital functions: mm/inch conversion, ABS/INC, on/off, zero-setting
- Rugged steel design
- Tungsten carbide measuring faces
- Hammertone finished frame with high quality insulated grip
- Tapered for easier access to difficult areas
- Constant force ratchet on thimble
- Locking lever
- Ball attachment included
- Supplied with settings standard over 25mm
- Supplied in case



DIGITAL EXTERNAL MICROMETER

Code No	Range (mm)	Range (inch)	Resolution (mm)	Resolution (inch)
MW201-01DAB	0-25	0-1	0.001	0.00005
MW201-02DAB	25-50	1-2	0.001	0.00005
MW201-03DAB	50-75	2-3	0.001	0.00005
MW201-04DAB	75-100	3-4	0.001	0.00005

Digital Absolute Snap Micrometer 202 Series

Features

- Absolute Measuring System
- USB Data output
- Digital functions: mm/Inch conversion, on/off, data-output, 0...ABS
- Non rotating spindle
- Constant measuring force on thimble
- Quick & repeatable measurement
- CR2032 battery



DIGITAL ABSOLUTE SNAP MICROMETER

Code No	Range (mm)	Range (inch)	Resolution (mm)	Resolution (inch)	Accuracy (mm)	Accuracy (inch)
MW202-01DABS	0-25	0-1	0.001	0.00005	0.003	0.00015
MW202-02DABS	25-50	1-2	0.001	0.00005	0.003	0.00015
MW202-03DABS	50-75	2-3	0.001	0.00005	0.004	0.0002
MW202-04DABS	75-100	3-4	0.001	0.00005	0.004	0.0002

DATA CABLE

Code No	Description
MW-Y100/700USB	Data Cable-USB to suit all DABS products

Large External Metric Micrometer 210 Series

Features

- Standard: DIN 863
- Tungsten carbide measuring faces
- Satin-chrome scale
- Strong forged steel hammertone finish frame with insulated grip
- Constant force ratchet on thimble
- Adjusting key
- Supplied with setting standards
- Supplied in wooden box



METRIC

Code No	Range (mm)	Resolution (mm)
MW210-01	100-125	0.01
MW210-02	125-150	0.01
MW210-03	150-175	0.01
MW210-04	175-200	0.01
MW210-05	200-225	0.01
MW210-06	225-250	0.01
MW210-07	250-275	0.01
MW210-08	275-300	0.01

Digital Large External Micrometer 210-DDL Series



Features

- Standard: DIN 863
- Digital functions: mm/inch conversion, on/off, zero-setting, battery low indication, hold, 0...ABS
- Tungsten carbide measuring faces
- Strong forged steel hammertone finish frame with insulated grip
- Constant force ratchet on thimble
- Supplied with setting standards and battery cover key
- Supplied in wooden box

EXTERNAL MICROMETER - Metric Only

Code No	Range (mm)	Resolution (mm)
MW210-01DDL	100-125	0.001
MW210-02DDL	125-150	0.001
MW210-03DDL	150-175	0.001
MW210-04DDL	175-200	0.001
MW210-05DDL	200-225	0.001
MW210-06DDL	225-250	0.001
MW210-07DDL	250-275	0.001
MW210-08DDL	275-300	0.001

Traditional Micrometer, Boxed Sets

Features

- Complies with BS870, DIN 863 / 1, ISO361
- Resolutions of 0.01mm or 0.002mm metric, 0.001" or 0.0001" imperial
- Tungsten carbide measuring faces
- 6.5mm spindle diameter for range between 0-150mm, 0-6"
- 6.8mm spindle diameter for range between 150-300mm, 6-12"
- Speeder type ratchet
- Locking lever
- Adjusting key
- Supplied with setting standards
- Supplied in fitted case



RESOLUTION 0.01MM

Code No	Range (mm)	Description	Quantity
MEB122M	0-75	Carbide anvils	3 Micrometers
MEB322M	0-150	Carbide anvils	6 Micrometers
MEB522M	0-300	Carbide anvils	12 Micrometers

RESOLUTION 0.002MM

Code No	Range (mm)	Description	Quantity
MEB222M	0-75	Carbide anvils	3 Micrometers
MEB422M	0-150	Carbide anvils	6 Micrometers
MEB622M	0-300	Carbide anvils	12 Micrometers

RESOLUTION 0.001"

Code No	Range (inch)	Description	Quantity
MEB122E	0-3	Carbide anvils	3 Micrometers
MEB322E	0-6	Carbide anvils	6 Micrometers
MEB522E	0-12	Carbide anvils	12 Micrometers

RESOLUTION 0.0001"

Code No	Range (inch)	Description	Quantity
MEB222E	0-3	Carbide anvils	3 Micrometers
MEB422E	0-6	Carbide anvils	6 Micrometers
MEB622E	0-12	Carbide anvils	12 Micrometers

Workshop External Micrometer Set 215 Series

Features

- Standard: DIN 863
- Tungsten carbide measuring faces
- Satin-chrome scale
- Satin-chrome forged steel frame with insulated grip
- Constant force ratchet on thimble
- Adjusting key
- Supplied with setting standards
- Supplied in wooden box



METRIC

Code No	Range (mm)	Resolution (mm)	Note
MW215-01BL	0-75	0.01	3 Micrometers In Set
MW215-02BL	0-100	0.01	4 Micrometers In Set
MW215-03BL	0-150	0.01	6 Micrometers In Set
MW215-04BL	0-200	0.01	8 Micrometers In Set

IMPERIAL

Code No	Range (inch)	Resolution (inch)	Note
MW215-01BLI	0-3	0.001	3 Micrometers In Set
MW215-02BLI	0-4	0.001	4 Micrometers In Set
MW215-03BLI	0-6	0.001	6 Micrometers In Set
MW215-04BLI	0-8	0.001	8 Micrometers In Set

Micrometer with Interchangeable Anvils 217 Series

Features

- Standard: DIN 863
- Features wide measuring range with interchangeable anvils
- Hardened and ground spindles/anvils
- Tungsten carbide measuring faces
- Satin-chrome scale
- Strong forged steel hammertone finish frame with insulated grip
- Constant force ratchet on thimble
- Adjusting key
- Supplied with setting standards
- Supplied in wooden box



METRIC

Code No	Range (mm)	Resolution (mm)
MW217-01	0-100	0.01
MW217-02	0-150	0.01
MW217-03	100-200	0.01
MW217-04	150-300	0.01
MW217-05	200-300	0.01

Analogue Snap Micrometer

Features

- Measuring range 0-25mm & 25-50mm
- Retractable anvil with an indicator for precise measurement of mass produced parts
- Micrometer accuracy 0.003mm
- Indicator accuracy 0.001mm
- Adjustable depth stop



METRIC

Code No	Range (mm)	Resolution (mm)	Indicator Range
MW290-01	0-25	0.001	+/- 0.04mm
MW290-02	25-50	0.001	+/- 0.04mm

Mechanical Digit Outside Micrometer 230 Series

Features

- Standard: DIN 863
- Low cost, mechanical/digital read-out micrometer
- Satin-chrome scale
- Forged steel frame with insulated grip
- Tapered for easier access to difficult areas
- With tungsten carbide measuring faces and constant force ratchet
- Packed in wooden/plastic box with standard and adjusting key



METRIC

Code No	Range (mm)	Resolution (mm)
MW230-01MDB	0-25	0.01
MW230-02MDB	25-50	0.01

Workshop Blade Micrometer 275 Series

Features

- Standard: DIN 863
- Measuring grooves, keyways etc.
- Blade 6.5mm non-rotating spindle
- Blade 1.25mm thick
- Satin chrome scale
- Hammertone finish frame with insulated grip
- Tapered for easier access to difficult areas
- Constant force ratchet on thimble
- Adjusting key
- Supplied in case



METRIC

Code No	Range (mm)	Resolution (mm)
MW275-01	0-25	0.01
MW275-02	25-50	0.01
MW275-03	50-75	0.01
MW275-04	75-100	0.01

Large Adjustable External Metric Micrometer 220 Series

Features

- Standard: DIN 863
- Features wide measuring range with interchangeable anvils
- Low weight tubular frame with insulated grips
- Tungsten carbide measuring faces
- Hardened and ground spindles/anvils
- Satin-chrome scale
- Constant force ratchet on thimble
- Adjusting key
- Supplied with setting standards
- Supplied in wooden box

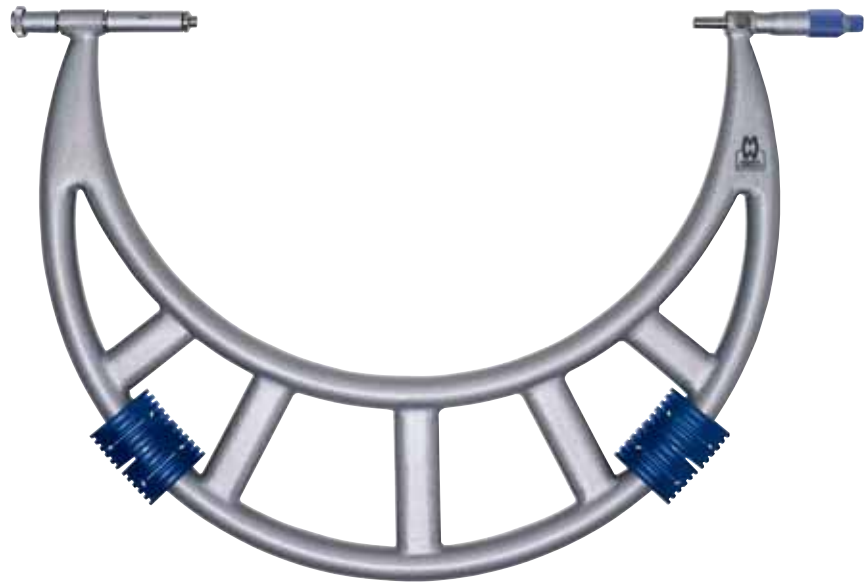

METRIC

Code No	Range (mm)	Resolution (mm)
MW220-01	300-400	0.01
MW220-02	400-500	0.01
MW220-03	500-600	0.01
MW220-04	600-700	0.01
MW220-05	700-800	0.01
MW220-06	800-900	0.01
MW220-07	900-1000	0.01
MW220-08	1000-1200	0.01
MW220-09	1200-1400	0.01

Large Adjustable External Digital Micrometer 220 Series

Features

- Standard: DIN 863
- Digital functions: tolerance indication, on/off, zero-setting, battery low indication
- Features wide measuring range with interchangeable anvils
- Low weight tubular frame with insulated grips
- Tungsten carbide measuring faces
- Hardened and ground spindles/anvils
- Satin-chrome scale
- Constant force ratchet on thimble
- Adjusting key
- Supplied with setting standards
- Supplied in wooden box

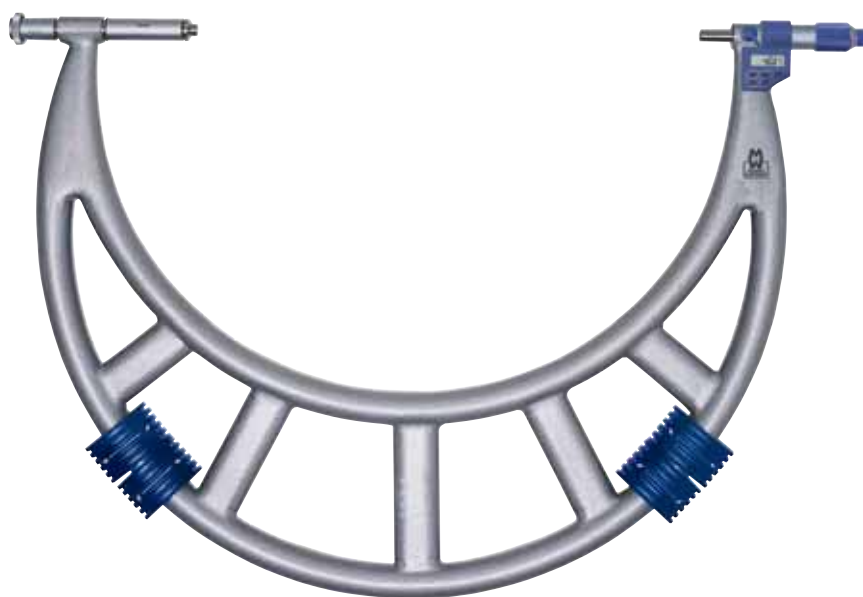

METRIC ONLY

Code No	Range (mm)	Resolution (mm)
MW220-01DDL	300-400	0.001
MW220-02DDL	400-500	0.001
MW220-03DDL	500-600	0.001
MW220-04DDL	600-700	0.001
MW220-05DDL	700-800	0.001
MW220-06DDL	800-900	0.001
MW220-07DDL	900-1000	0.001

Tube Micrometer 255 Series

Features

- Standard: DIN 863
- Spherical anvil for measuring tube wall thickness
- Tungsten carbide measuring faces on spindle
- Satin chrome scale
- Hammertone finished frame with insulated grip
- Constant force ratchet on thimble
- Supplied in case



METRIC

Code No	Range (mm)	Resolution (mm)	Accuracy (mm)	Dimn - A	Dimn - B
MW255-01	0-25	0.01	0.006	4.75	27.5

Digital Tube Micrometer 255-DDL Series

Features

- Standard: DIN 863
- Digital functions: mm/inch conversion, on/off, zero-setting, battery low indication, hold, 0...ABS
- Spherical anvil for measuring tube wall thickness
- Tungsten carbide measuring faces on spindle
- Chrome plated frame with high quality insulated grip
- Constant force ratchet on thimble
- Supplier with battery cover key
- Supplied in case
- IP54 rated



METRIC / IMPERIAL

Code No	Range (mm)	Range (inch)	Resolution (mm)	Resolution (inch)	Accuracy (mm)	Dimn - A	Dimn - B
MW255-01DDL	0-25	0-1	0.001	0.00005	0.003	27.5	4.75

Point Micrometer 270 Series

Features

- Standard: DIN 863
- Pointed spindle and anvil for measuring hard to reach places like the web thickness of drills, small grooves, keyways
- Tungsten carbide measuring faces
- Hammertone finished frame with high quality insulated grip
- Tapered for easier access to difficult areas
- Constant force ratchet on thimble
- Locking lever
- Adjusting key
- Supplied with settings standard
- Supplied in case



METRIC

Code No	Range (mm)	Resolution (mm)	Accuracy (mm)	Point Angle
MW270-01	0-25	0.01	0.004	15°
MW270-02	25-50	0.01	0.004	15°
MW270-03	50-75	0.01	0.005	15°
MW270-04	75-100	0.01	0.005	15°
MW270-05	0-25	0.01	0.004	30°
MW270-06	25-50	0.01	0.004	30°
MW270-07	50-75	0.01	0.005	30°
MW270-08	75-100	0.01	0.005	30°

Workshop Digital Point Micrometer 270 Series

Features

- Standard: DIN 863
- Large LCD display
- Digital functions: mm/inch conversion, ABS/INC, on/off, zero-setting, battery low indication
- Pointed spindle and anvil for measuring hard to reach places like the web thickness of drills, small grooves, keyways
- Tungsten carbide measuring faces
- Hammertone finished frame with high quality insulated grip
- Tapered for easier access to difficult areas
- Constant force ratchet on thimble
- Locking lever
- Adjusting key
- Supplied with settings standard
- Supplied in case



METRIC / IMPERIAL

Code No	Range (mm)	Range (inch)	Resolution (mm)	Resolution (inch)	Accuracy (mm)	Point Angle
MW270-01DDL	0-25	0-1	0.001	0.00005	0.004	30°
MW270-02DDL	25-50	1-2	0.001	0.00005	0.004	30°
MW270-03DDL	50-75	2-3	0.001	0.00005	0.005	30°
MW270-04DDL	75-100	3-4	0.001	0.00005	0.005	30°

Caliper Type Inside Micrometer 280 Series

Features

- Standard: DIN 863
- Measuring the inside of a bore or hole
- Pin diameter 2mm, length 5mm (only applicable to MW280-01)
- Satin chrome finished frame
- Constant force ratchet thimble
- Locking clamp for positive locking of spindle
- Adjusting key
- Supplied in case



MW280-01



MW280-04

CALIPER TYPE INSIDE MICROMETER

Code No	Range (mm)	Resolution (mm)	Accuracy (mm)	Setting Rings
MW280-01	5-30	0.01	0.005	Yes
MW280-02	25-50	0.01	0.005	Yes
MW280-03	50-75	0.01	0.005	No
MW280-04	75-100	0.01	0.005	No
MW280-05	100-125	0.01	0.005	No
MW280-06	125-150	0.01	0.005	No
MW280-07	150-175	0.01	0.005	No
MW280-08	175-200	0.01	0.005	No

Digital Inside Micrometer 280-DDL Series

Features

- Standard: DIN 863
- Digital functions: mm/inch conversion, on/off, zero-setting, battery low indication, hold, 0...ABS
- Measuring the inside of a bore or hole
- Pin diameter 2mm, length 5mm (only applicable to MW280-01DDL)
- Satin chrome finished frame
- Constant force ratchet thimble
- Locking clamp for positive locking of spindle
- Supplied in case



MW280-01DDL



MW280-05DDL

DIGITAL CALIPER TYPE INSIDE MICROMETER

Code No	Range (mm)	Range (inch)	Resolution (mm)	Resolution (inch)	Accuracy (mm)	Setting Rings
MW280-01DDL	5-30	0.2-1.2	0.001	0.00005	0.003	Yes
MW280-02DDL	25-50	1-2	0.001	0.00005	0.003	Yes
MW280-03DDL	50-75	2-3	0.001	0.00005	0.004	No
MW280-04DDL	75-100	3-4	0.001	0.00005	0.004	No
MW280-05DDL	100-125	4-5	0.001	0.00005	0.005	No
MW280-06DDL	125-150	5-6	0.001	0.00005	0.005	No

Tubular Internal Micrometer 300 Series

Features

- Standard: DIN 863
- Ideal for large diameters
- Tungsten carbide measuring faces
- All measuring faces are micro-lapped
- Satin-chromed scale and body with lock screw
- Supplied with setting piece
- Supplied in a wooden box

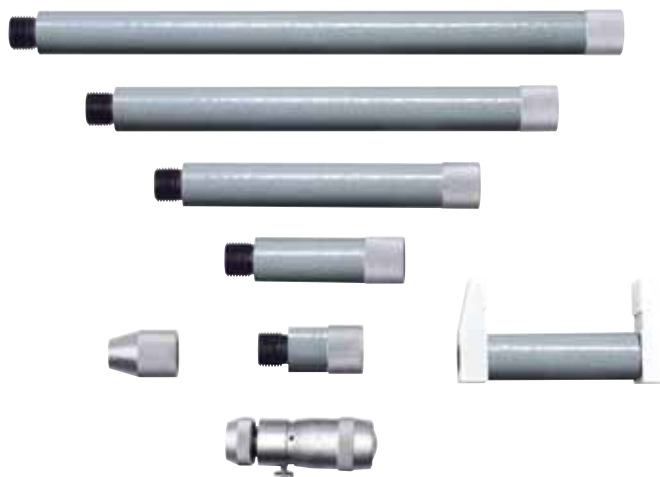

Assembled Micrometer

METRIC

Code No	Range (mm)	Resolution (mm)
MW300-01	50-250	0.01
MW300-02	50-600	0.01
MW300-04	150-2000	0.01

Traditional Internal Micrometers 900 Series

Each model comprises a measuring head, a set of extension rods and a spacing collar to facilitate alternative measuring ranges. The smaller models (901, 902 & 903) have detachable extension handles.

All models supplied in a fitted case.

Features

- Complies with: BS959



METRIC

Code No	Range (mm)	Accuracy (mm)	Head Range (mm)
901M	25-55	0.003	5
902M	50-210	0.003	10
903M	50-310	0.003	10
908M825	200-825		25

IMPERIAL

Code No	Range (inch)	Accuracy (inch)	Head Range (inch)
901	1-2	0.0001	0.25
902	2-8	0.0001	0.50
903	2-12	0.0001	0.50

Traditional Depth Micrometer

Complies with BS6468:1984

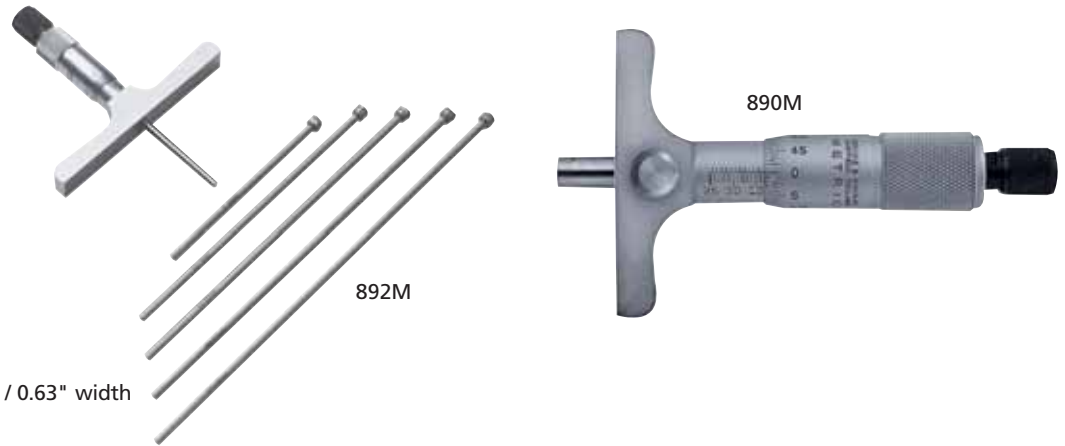

890 Series:

- Fixed depth rod, 6.5mm diameter
- 63.5mm / 2 1/2" base length 16mm / 0.63" width
- 'Speeder' type ratchet
- Lock screw

891 Series:

- Interchangeable depth rods, 4.5mm diameter
- 63.5mm / 2 1/2" base length, 16mm / 0.63" width

892 Series:

- As 891 Series except for: 100mm / 4" base length

METRIC

Code No	Range (mm)
890M	0-25
891M75	0-75
891M150	0-150
891M300	0-300
892M75	0-75
892M150	0-150
892M300	0-300

IMPERIAL

Code No	Range (inch)
890	0-1
8913	0-3
8916	0-6
89112	0-12
8923	0-3
8926	0-6
89212	0-12

Digital Depth Micrometer 305-DDL Series

Features

- Standard: DIN 863
- Digital functions: mm / inch conversion, set, on/off, zero-setting, battery low indication, hold, 0...ABS
- Interchangeable rods (spherical ends)
- Rods are hardened and spherically lapped
- Satin chrome finished base
- Constant force ratchet on thimble



METRIC / IMPERIAL

Code No	Range (mm)	Range (inch)	Resolution (mm)	Resolution (inch)	Accuracy (mm)	Size of Base (mm)
MW305-00DDL	0-25	0-1	0.001	0.00005	0.004	100
MW305-01DDL	0-50	0-2	0.001	0.00005	0.004	100
MW305-02DDL	0-100	0-4	0.001	0.00005	0.005	100
MW305-03DDL	0-150	0-6	0.001	0.00005	0.006	100
MW305-04DDL	0-200	0-8	0.001	0.00005	0.007	100
MW305-05DDL	0-300	0-12	0.001	0.00005	0.009	100

Extra Small Micrometer Head 310 Series

Features

- Universal micrometer head for incorporating into machines or other purposes
- Satin chrome finished body
- Laser engraved graduations

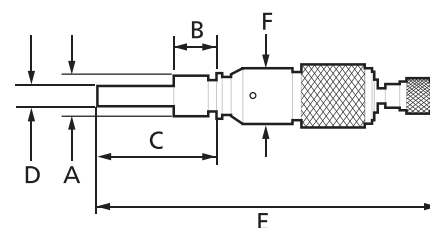

METRIC

Code No	Range (mm)	Note	Resolution (mm)	Dimn - A	Dimn - B	Dimn - C	Dimn - D	Dimn - E	Dimn - F
MW310-05	0-5	Measuring Face - Flat	0.01	3.5	5.00	12.00	2.00	32.00	6.00
MW310-05R	0-5	Measuring Face - Spherical	0.01	3.5	5.00	12.00	2.00	32.00	6.00

Small Micrometer Head 310 Series

Features

- Universal small micrometer head for incorporating into machines or other purposes, easy to read due to large thimble
- Satin chrome finished body
- Laser engraved graduations

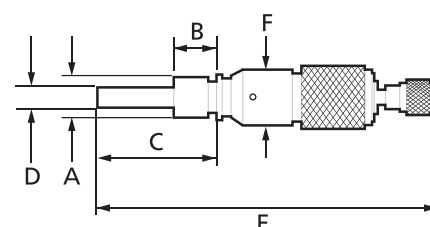

METRIC

Code No	Range (mm)	Note	Resolution (mm)	Dimn - A	Dimn - B	Dimn - C	Dimn - D	Dimn - E	Dimn - F
MW310-06	0-6.5	Flat Anvils	0.01	6.00	8.00	15.00	3.50	37.00	10.00
MW310-06R	0-6.5	Spherical Anvils	0.01	6.00	8.00	15.00	3.50	37.00	10.00

Small Micrometer Head 310 Series

Features

- Spindle diameter 5mm
- Universal small micrometer head for X-Y stages or other purposes
- Satin-chrome finished body
- Laser engraved graduations

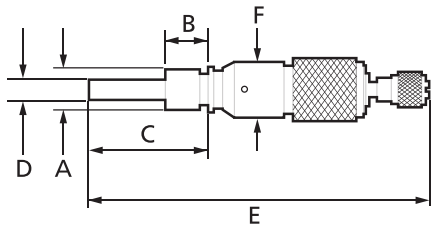

METRIC									
Code No	Range (mm)	Note	Resolution (mm)	Dimn - A	Dimn - B	Dimn - C	Dimn - D	Dimn - E	Dimn - F
MW310-13	0-13	Measuring Face - Flat	0.01	9.50	10.50	24.00	5.00	59.00	13.50

Small Micrometer Head 310 Series

Features

- Standard: Factory Standard
- Spindle diameter 5mm
- Universal micrometer head for X-Y stages or other purposes
- Satin-chrome finished body
- Laser engraved graduations

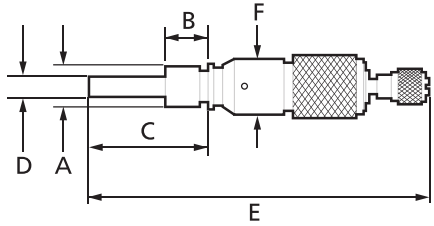

METRIC									
Code No	Range (mm)	Note	Resolution (mm)	Dimn - A	Dimn - B	Dimn - C	Dimn - D	Dimn - E	Dimn - F
MW310-15	0-15	Spherical anvil	0.01	9.50	9.50	26.00	5.00	61.00	13.50